

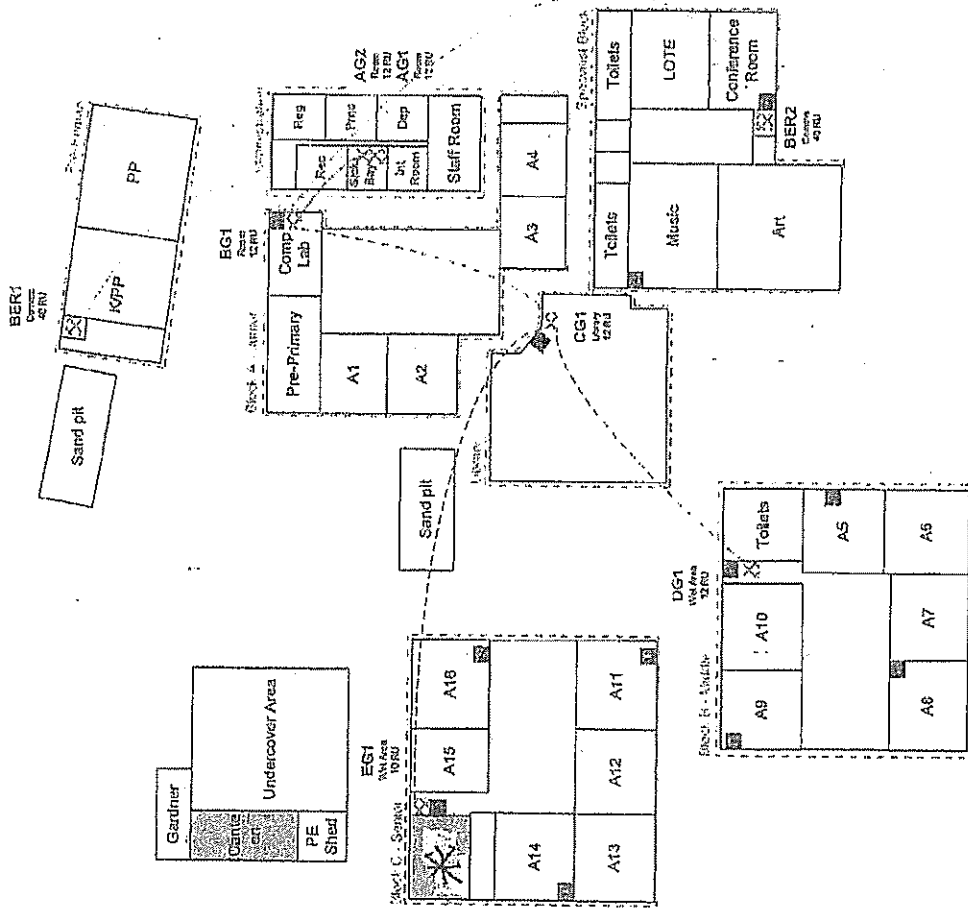

OSHC - YMCA ROOM *



N.A.L.
5/12/2016
27/8/18

<p>Department of Education Woodvale PS SOE4 Physical</p>	<p>Originator: Craig Davidson Latest By: Leigh Gilbert Date: 12-Aug-2016</p>	<p>Base IP: 10.144.10.0/21 Cable: 5688 Demand: Ellus WAN Link: 10 MBit/sec</p>	<p>LEGEND: AG1 S SPS Wireless Access Point (WAP) Proposed WAP Install Available WAP Data Point</p>
<p>Existing Communications Cabinet New Communications Cabinet New Communications Cabinet - position to be determined Remove Communications Cabinet</p>	<p>Cabinet (A) on Ground Floor (G) being first cabinet (1) on that level Wireless Access Point (WAP) Proposed WAP Install Available WAP Data Point</p>	<p>Existing OM1 (62.5) Optical Fibre Existing OM3 (50) Optical Fibre New OM1 (9) Single Mode Optical fibre New cabling Cat56 4x lines</p>	<p>Y:\Schools\Woodvale\Physical\Diagram.vxd</p>